

11 10 9 8 7 6 5 4 3 2 1

TYPE	OUTPUT		POLE	TIME RATING	VOLTAGE V	Hz	SYN.SPEED R.P.M
	HP.	KW.					
AEHH8P	150	111.9	4	CONT.	460	60	1800

TOTALLY ENCLOSED FAN-COOLED TYPE, SQUIRREL-CAGE ROTOR

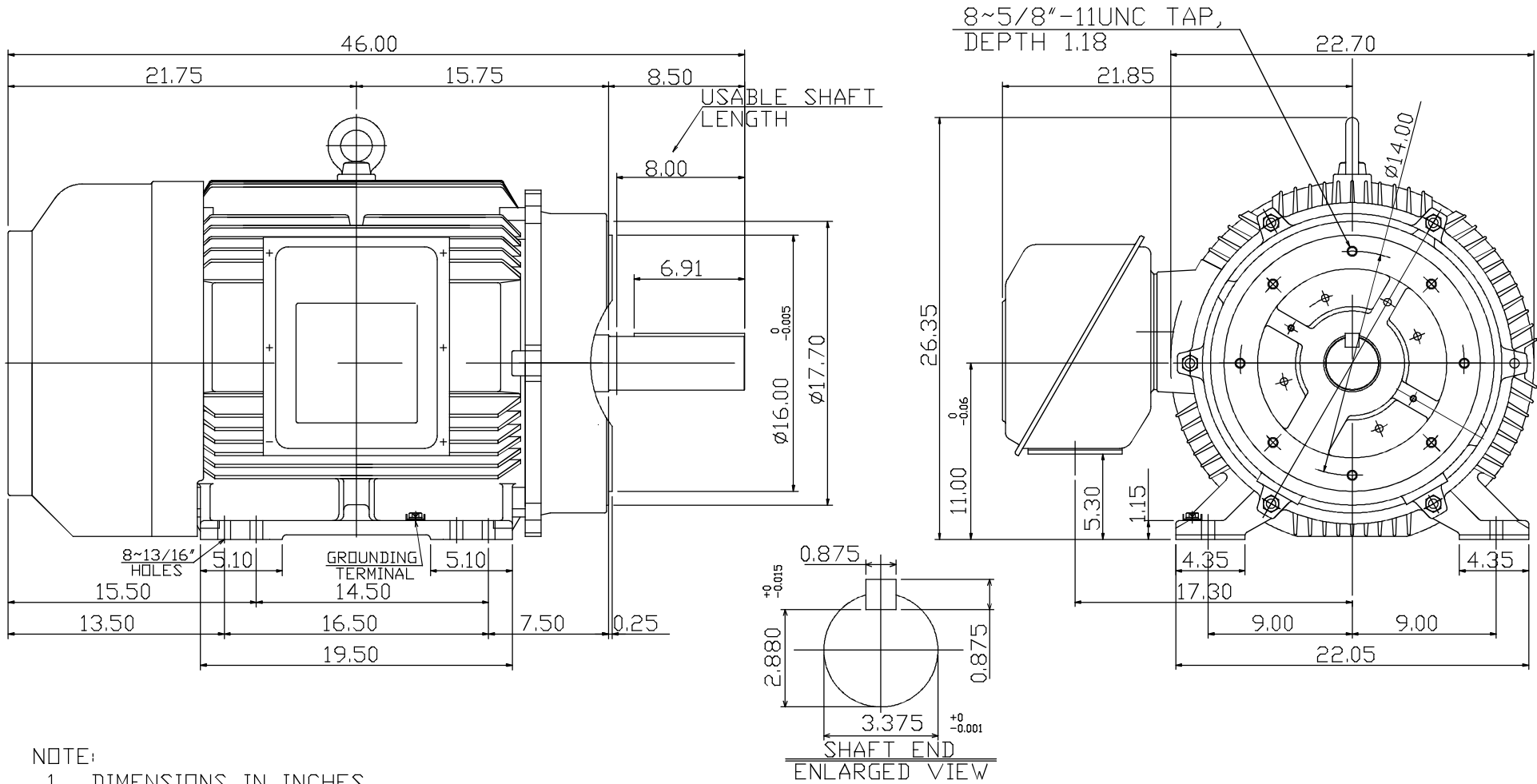

NOTE:

1. DIMENSIONS IN INCHES
2. FRAME SIZE 445TC
3. F CLASS INSULATION, S.F. 1.15
4. FOR DIRECT FLEXIBLE COUPLING
5. BEARING NO.: DRIVE END: 6318C3
OPP. DRIVE END: 6316C3
6. ENCLOSURE: IP44
7. APPROX. WEIGHT: 1700 LBS

DATE	JAN. 6, 2012	OUTLINE DIMENSIONS
CATALOG #:	NP1504C	

DWN.	S.LEE	JAN•26•2011
CHKD.	S.LEE	JAN•26•2011
APPD.	H.LIU	JAN•26•2011

TECO Westinghouse

DWG NO. REV: 01
3A049DWB10464-26

11 10 9 8 7 6 5 4 3 2 1